

The Nightwatch

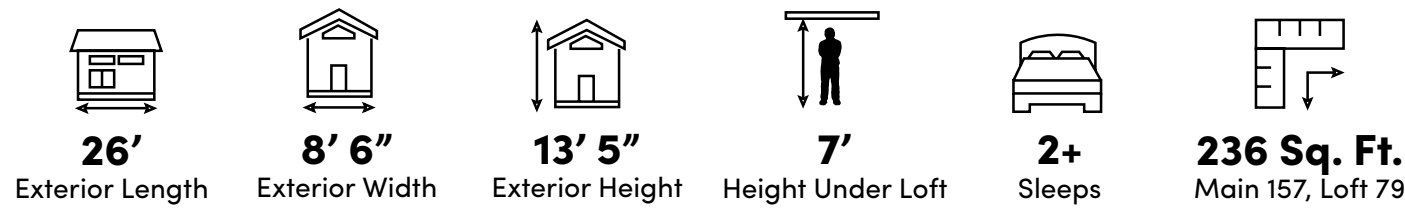

Let's Plan Your **TinyDreamHOME**.
TinyDreamHOMES.com
1-877-GO-4-TINY

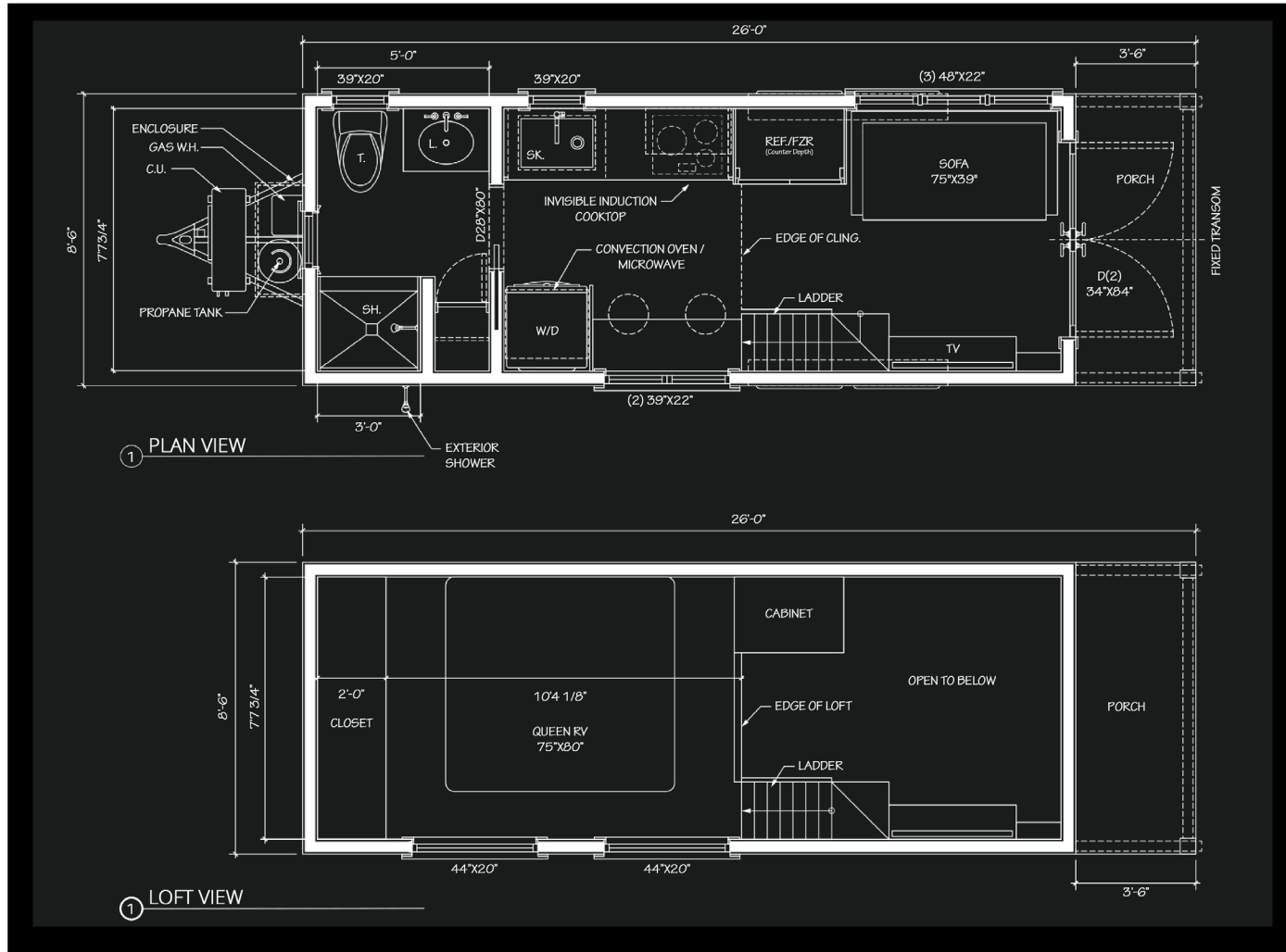

The general information contained herein is informational only and is not intended to be relied upon as a representation of all aspects of TinyDreamHOMES. TDH reserves the right to change without notice any of the specifications, dimensions, appliances, equipment, features, pricing, and materials in its sole discretion due to changes in manufacturing, design, availability of parts and materials, pricing, product specifications, or such other reasons.



The Nightwatch

Built for Comfort, Designed for Adventure.

TinyDreamHOMES.com

The Nightwatch

TinyDreamHOMES.com™



Queen Size
Sleeping Loft

Impact
Resistant
Insulated
Windows

Invisible
Induction
Cooktop

Built-in
Dog Bowls

Beam-style
Front Porch

Concealed
Gun Cabinet

Built in
Bar/Desk

Porcelain-
tiled Shower

Why Choose The Nightwatch?

The 26' Nightwatch is a dream come true for a Sportsman and his family. Relax in the perfect Tiny Dream Home after a day on the lake, at the race, or wherever your adventures have taken you.

The Nightwatch will feel like an extension of your family's home, with a luxury equipped kitchen featuring stainless appliances, shaker-style cabinets, utility closet, clever storage beneath the stairs, and a built-in locking cabinet ensuring your equipment is safe and protected. A bar for mealtime conveniently doubles as a desk.

The spacious sleeping loft includes a large wardrobe spanning the entire width of the house with an additional storage closet. Enjoy a beautiful spa-like bathroom with heated floors and a walk-in shower finished in porcelain tile.

You'll love the integrated, stylish, beam-style front porch with an expansive double French door as your gateway to enjoy the outdoors!

Built with Luxury. Backed by Warranty.

Home Certification

Tiny Dream HOMES are dual inspected by NOAH to both the 2023 NOAH+ standard and 2023 NOAH Dwelling Standard which includes ANSI 119.5, NFPA 70 (NEC) and 2018 IRC (International Residential Code, including Appendix AQ). Additionally, the NOAH Dwelling Standard requires and inspects for provisions per the following stipulations of AWC and APA codes.

Home Warranty

One-year limited warranty on workmanship. Pass through warranties on appliances and certain materials.

Key Features of The Nightwatch

Kitchen Appliances

Efficient full-size stainless refrigerator, Invisacook induction cooktop, turbo speed oven with built-in air fryer and microwave.

Kitchen Cabinetry

Custom-built shaker-style cabinets with pre-finished wood interiors & brushed nickel hardware.

Kitchen Countertops

3/4" solid surface Dekton® countertops with 6" back-splash. Matte black faucet & undermount stainless sink.

Master Bath

Walk-in shower with porcelain tile. 30" vanity cabinet with solid surface counter & undermount sink.

Heating/Cooling

18,000 BTU energy-efficient ductless mini-split A/C and heat pump.

Laundry

Versatile LG WashCombo™ All-in-One 5.0 cu. ft. Mega Capacity Ventless Washer/Dryer with Inverter HeatPump™ Technology.

Off-grid Solar Package (optional)

Conduit is pre-installed for easy installation of an optional Solar Package, which includes a propane cooktop and incineration toilet.

Floors

7-1/2" wide European White Oak engineered wood floors.

Windows

ES Windows Prestige® Line casement and fixed aluminum windows with thermally-broken, insulated, impact-resistant glass.

Outdoor Shower

A convenient outdoor shower for clean-up.

*Specifications subject to change due to availability and pricing